



LIFE WITH ETERNAL COMFORT



Madhuvan Group is a veteran real estate group in Vadodara, with nearly three decades of experience in the field. Known for its aesthetics and innovation in construction approach, the group includes young and dynamic professionals as part of its team. Madhuvan Group is presently scaling new heights of excellence and brilliance in more ways than one.

The group is keen to initiate projects that will define the architectural horizon of several cities, while becoming a landmark in itself for the urban residents.

A PLACE WHERE LUXURY IS A WAY OF LIFE



THE
MARK
3 & 4 BHK ORNATE LIVING



VISION LOOKS UPWARD AND BECOMES FAITH

The Mark is there to boost up the self-esteem of residing community, it has a basket full of advantages beautiful look, green living, secure and safe premises.





A PLACE WHERE JOY RESIDES EVERYWHERE

Project has an amazing infrastructure which will sincerely improve lifestyle



LAYOUT PLAN





4 BHK UNIT PLAN

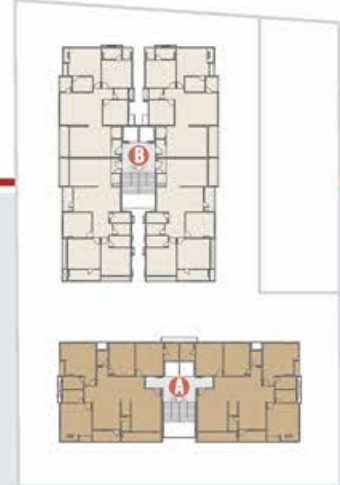

— BLOCK - A —

SECTION VIEW





A PLACE WHERE COMFORT IS A WAY OF YOUR LIFESTYLE

Breathtaking Views in Every Direction with trust inside and out at The Mark. Lead back the most excellent times of your life with a new natural vision in an attractive lifestyle. Feel the calmness in every angle because it's designed for an extraordinary living



3 BHK UNIT PLAN (TYPE - 1)



SECTION VIEW

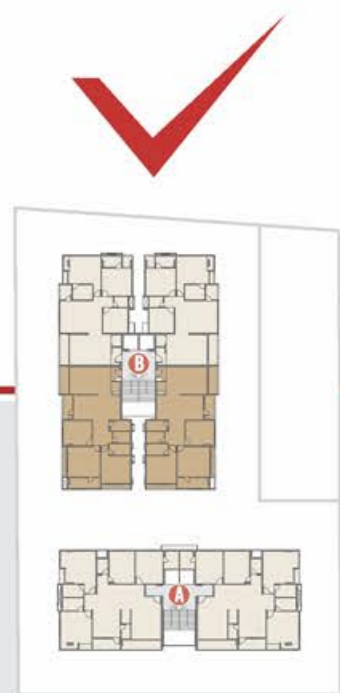

BLOCK - B

3 BHK UNIT PLAN (TYPE - 2)

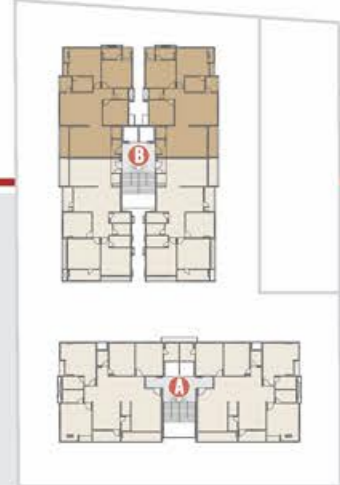

— BLOCK - B —

SECTION VIEW





CLUB HOUSE PLAN

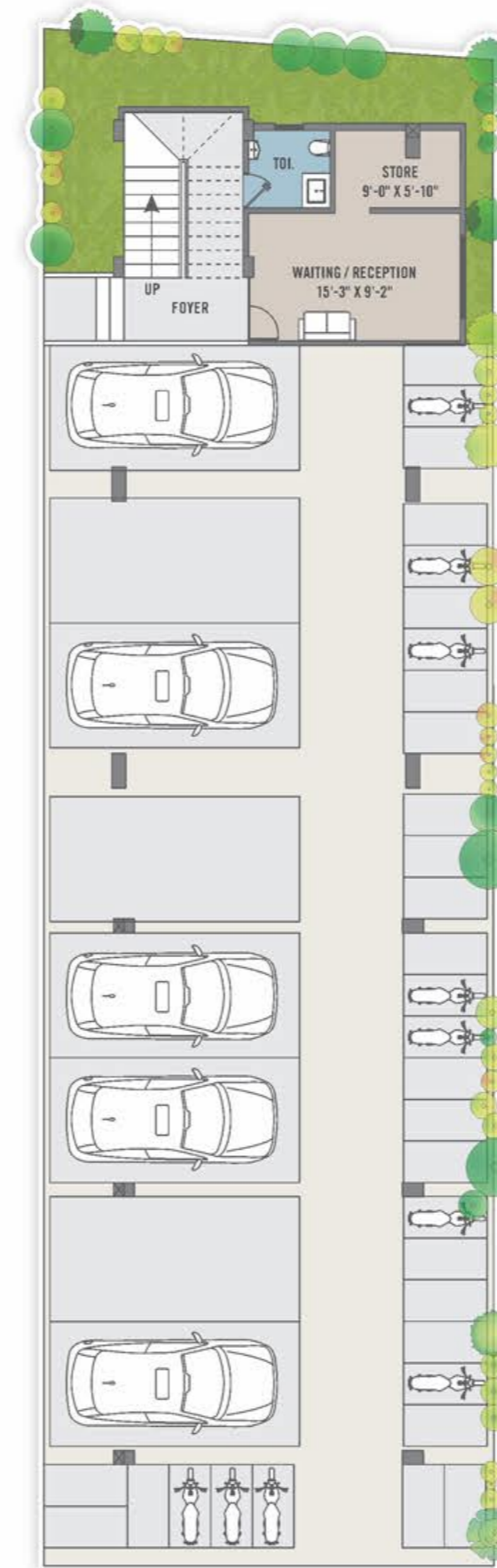

— GROUND FLOOR —

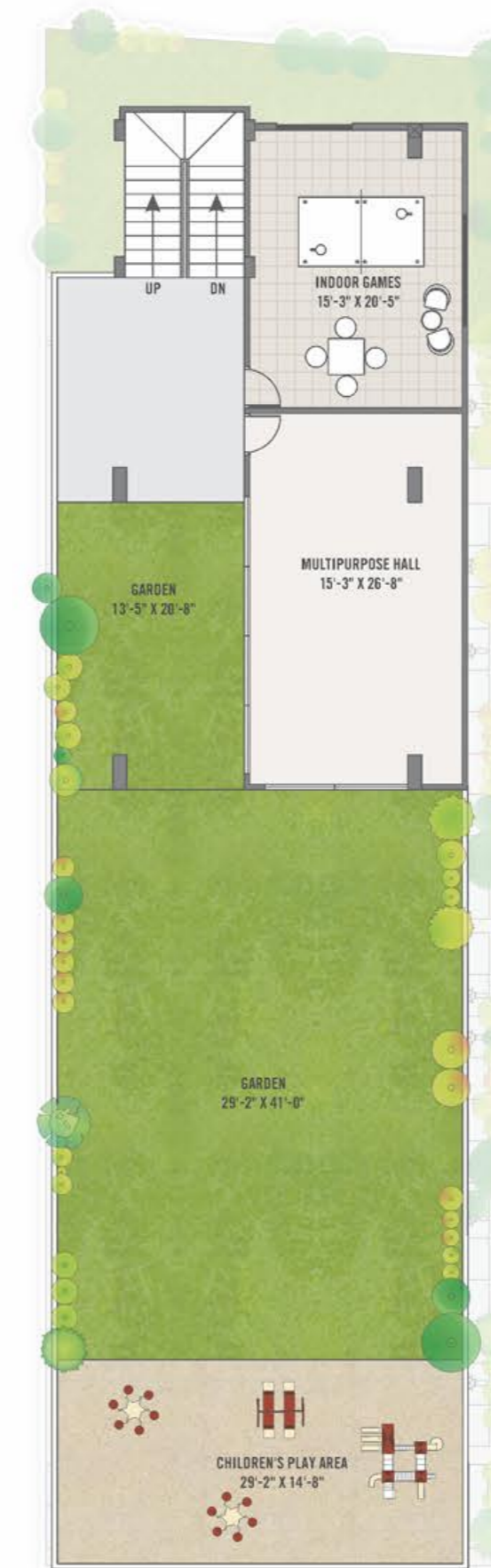

— FIRST FLOOR —

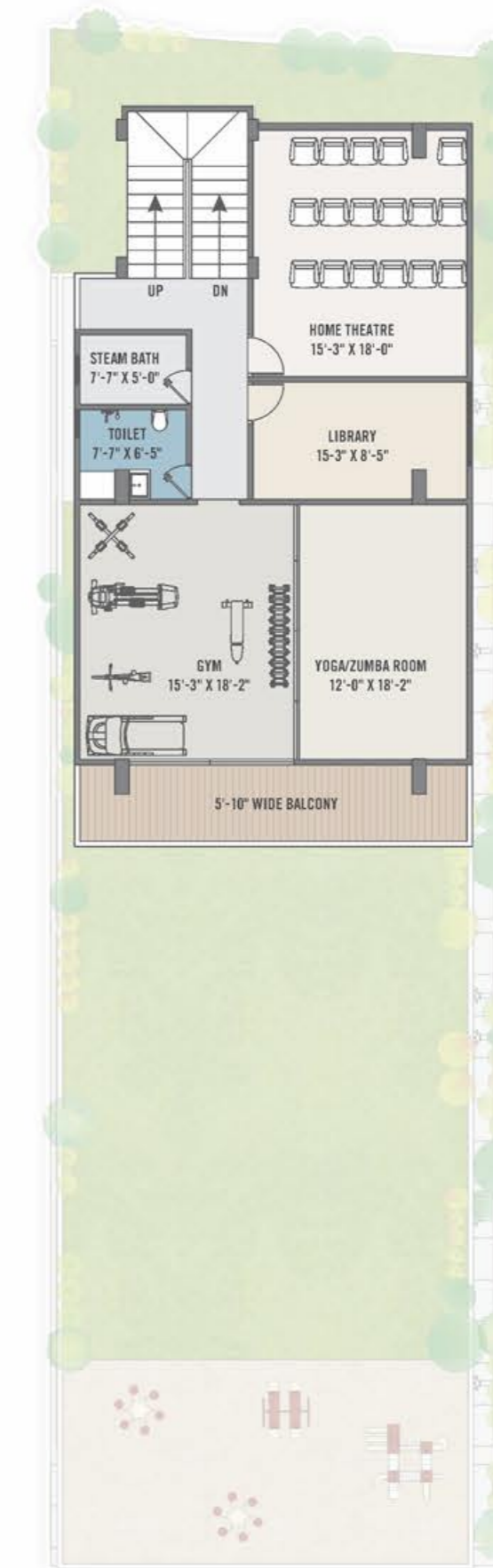



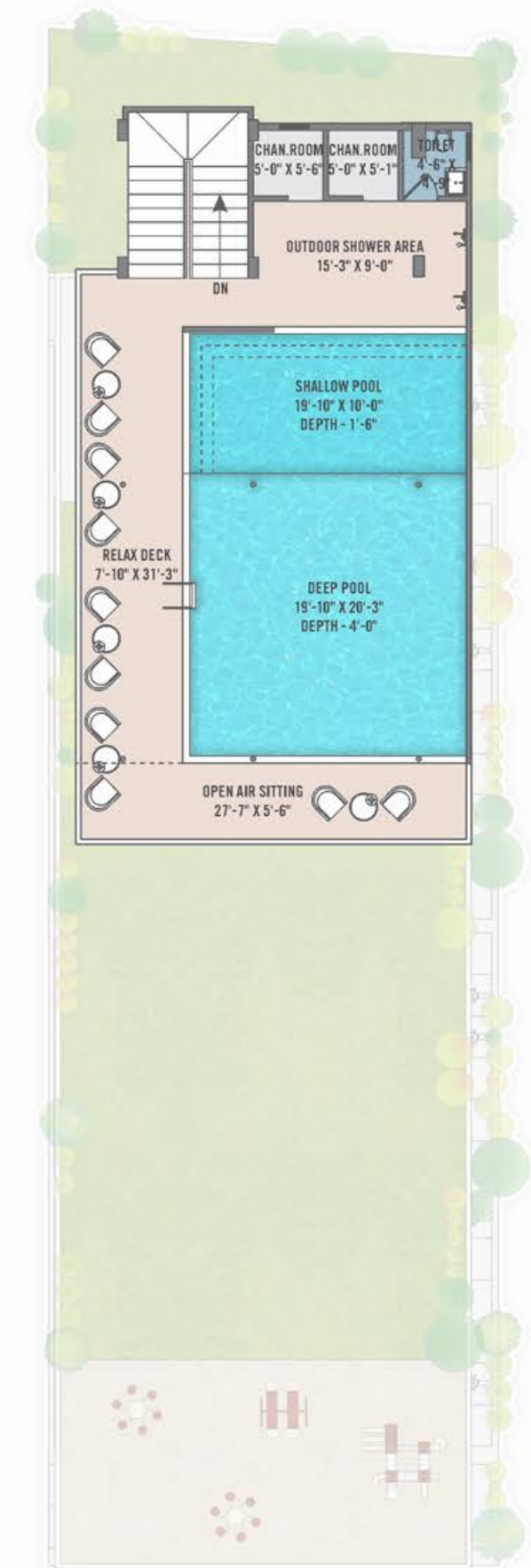













— SECOND FLOOR —



— THIRD FLOOR —



LEISURE AMENITIES

- | | | | | | |
|--|--|---|--|--|---|
| 
MULTIPURPOSE HALL | 
INDOOR GAMES | 
GYM | 
YOGA & ZUMBA | 
LIBRARY | 
STEAM BATH |
| 
GARDEN | 
SR. CITIZEN SEATING | 
BARBEQUE ZONE | 
GAZEBO | 
CCTV CAMERA | 
CHILDREN PLAY AREA |
| 
ALLOTTED PARKING | 
HOME THEATER | 
SWIMMING POOL | 
POWER BACKUP COMMON AREA | | |

Say hello to the world of extravagant living where lives harmony & tranquillity. To celebrate all those special occasions of your life there is a fabulous house, just for you!



THE MARK

VALUABLE FEATURES

- Elegance entrance gate
- DG power back-up for common area & elevators
- 24x7 water supply
- 24x7 security with security cabin
- Allotted car parking (basement & ground floor)
- Trimix Internal roads with street lights, decorative paving & architectural plantation
- Anti-termite treatment in ground level
- Fire safety for each tower
- Two High quality passenger lifts in each tower
- Decorative name plate & letter box
- Decorative foyer entrance on ground floor
- Ro water purifier system
- Video door sec. system
- POP Ceiling with LED lights
- Electric Geysers in all bathrooms
- Chimney
- Safety grill in all window
- Rain water harvesting



THE MARK

SPECIFICATION

STRUCTURE		<ul style="list-style-type: none">• Earthquake resistant R.C.C Frame Structure designed by approved Structural consultant.
FLOORING		<ul style="list-style-type: none">• Premium quality vitrified tiles in rooms.• Anti-skid flooring in bath, wash Area.
WALL FINISH		<ul style="list-style-type: none">• Interior : Smooth finish plaster with putty, primer & colour.• Exterior : Double coat plaster with texture & weather coat paint.
ELECTRIFICATION		<ul style="list-style-type: none">• 3-phase concealed copper wiring As per ISI standard norms.• Modular switches.• Adequate electric points in each room as per architect's drawing• A.C. Point in all rooms.• TV point in living room and master bedroom.• Separate MCB for each room.
KITCHEN		<ul style="list-style-type: none">• Premium quality sandwich platform with S.S. sink.• Decorative glazed tiles dado-up to lintel level.
BATHROOM		<ul style="list-style-type: none">• Designer bathroom with premium quality bath fitting and sanitary wares.• Premium quality ceramic tiles dado up to lintel level.
DOORS		<ul style="list-style-type: none">• Main door : High quality decorative door with wooden frame.• Internal doors : Laminated flush door with granite frame.
WINDOWS		<ul style="list-style-type: none">• Colour Anodized Aluminium sliding window with fully glass shutters.• Stone frame for window.
TERRACE		<ul style="list-style-type: none">• Elegant china mosaic finish with water & Heat proofing treatment.





PAYMENTS

- 30 % BOOKING • 10 % PLINTH LEVEL • 10 % 2ND FLOOR
- 10 % 4TH FLOOR • 10 % 6TH FLOOR • 10 % 8TH FLOOR
- 10 % 10TH FLOOR • 5 % PLASTER LEVEL • 5 % POSSESSION

NEAR BY PLACE



SHOPPING & ENTERTAINMENT
 • Croma • Zudio • Westside
 • Harni Super Market • Lake Zone



SCHOOLS & COLLEGES
 • Ambe School • Bright Day School
 • Cygnus School • D.P.S School • D.R. Amin School



HEALTH CARE
 • Pranayam Lung Institute • Shukan Hospital
 • Rhythm Hospital • Jahnvi Multispeciality



BANKS/ATM
 • ICICI Bank • SBI Bank • Axis Bank • B.O.B
 • Union Bank • HDFC Bank & ATM

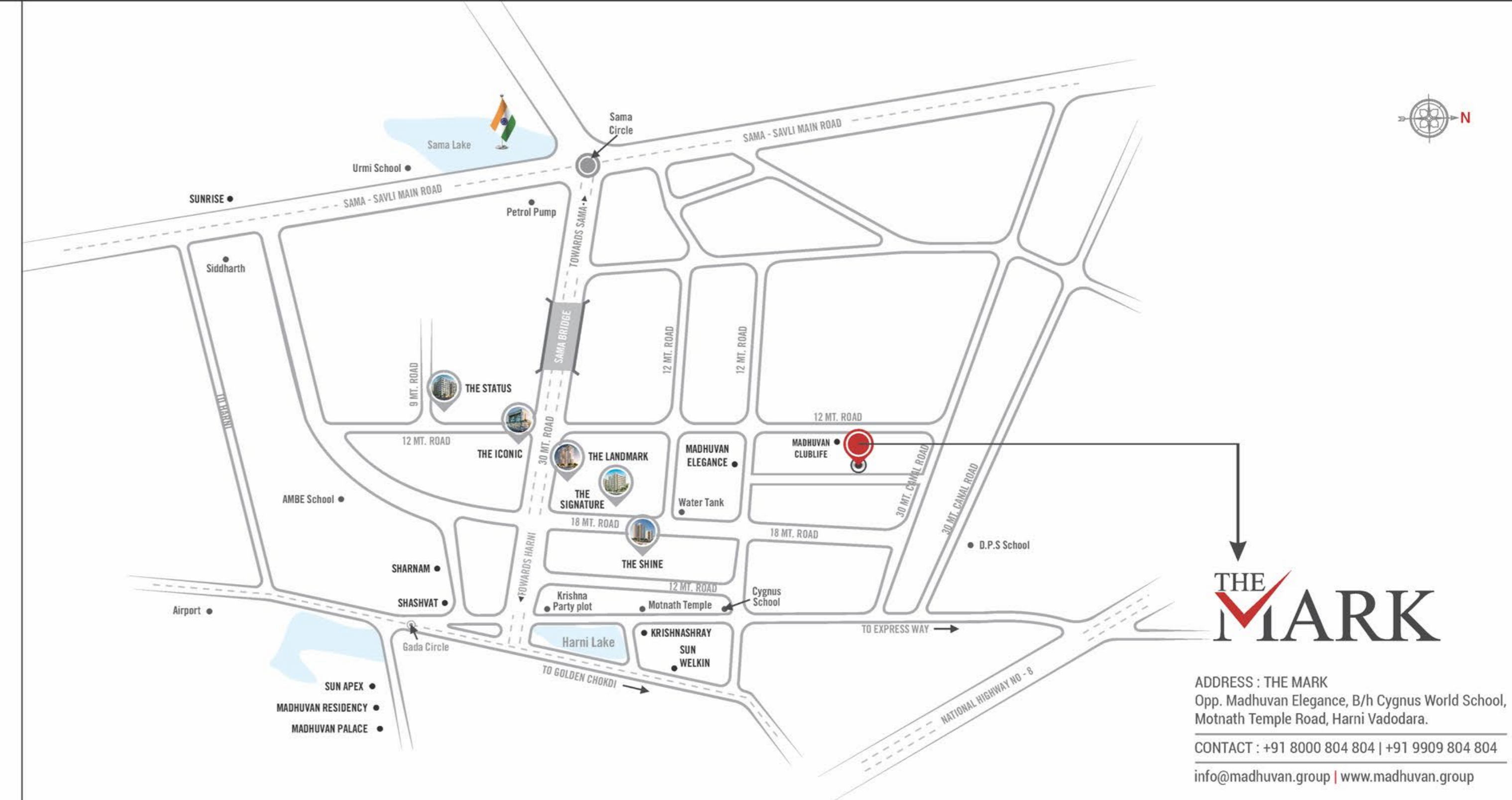

THE MARK

ADDRESS : THE MARK
 Opp. Madhuvan Elegance, B/h Cygnus World School,
 Motnath Temple Road, Harni Vadodara.

CONTACT : +91 8000 804 804 | +91 9909 804 804
 info@madhuvan.group | www.madhuvan.group

DEVELOPER

madhuvan
INFRA

ARCHITECT

CHETAL
ARCHITECTS & ENGINEERS

STRUCTURE ENG.

ASHOK SHAH
& ASSOCIATES
CONSULTING ENGINEERS

MEP

Original Electricals
Engineers & Consultants

Developers reserve the rights for alteration of specification and design. All dimensions / area are approximate, average & subject to variations. Irregular payments shall cause cancellation of booking. VMC, electricity, legal expenses, GST & other GOVT charges, stamp duty & registration, maintenance charges & meter charges shall be borne by the members. This brochure is not to be treated as part of the legal document, it is for the easy presentation of the project.

Disclaimer : the details, facts, specifications, figures mentioned in brochure are indicative for information purpose only and are subject to modifications/compliance required as per RERA act.

SCAN ME
LOCATION



SCAN ME
BROCHURE

